

TRIO NEWTON: RETAIL LEASING OPPORTUNITIES



PROJECT ORIENTATION

Located at the corner of Walnut and Washington Street in Newtonville, Trio Newton sits at one of the most active pedestrian and vehicular corridors in the City of Newton.

The 42,000 SF of ground floor retail at Trio Newton is immediately adjacent to the MBTA Commuter Rail and below 140 new residential units. Developed with 99 new retail parking spots, Trio Newton is anchored by a 15,000 SF pedestrian plaza.

Ownership seeks best-in-class local operators to populate said spaces and is currently engaging interested parties.



LOCATION



LOCATION

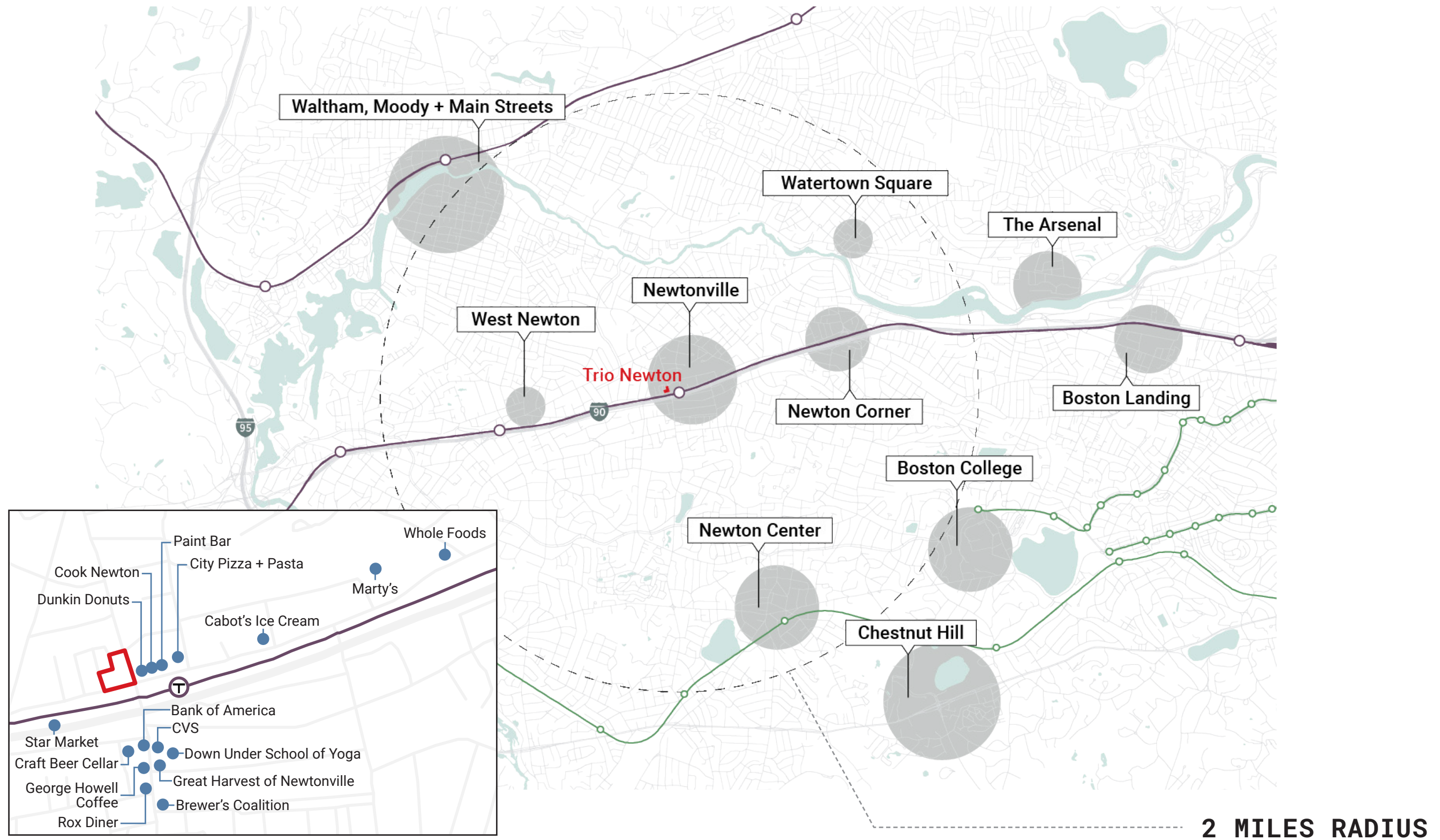

IN THE NEIGHBORHOOD

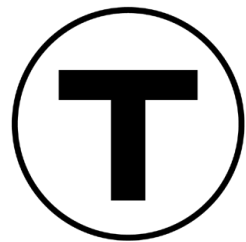

3

stops to Back Bay on
the Commuter Rail



150

bicycle parking
spots



42,000

square feet of retail



99

designated retail
parking spots

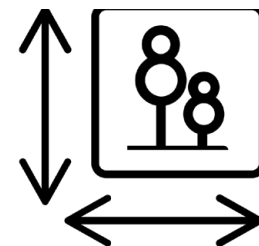

15,000

square feet of public
outdoor space



87,000

people living in Newtown

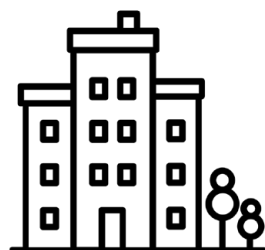

140

new residential units

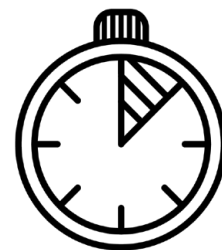

21,700

people living within a
15-minute walk



\$125,080

median household
income within one mile

FLOOR PLAN

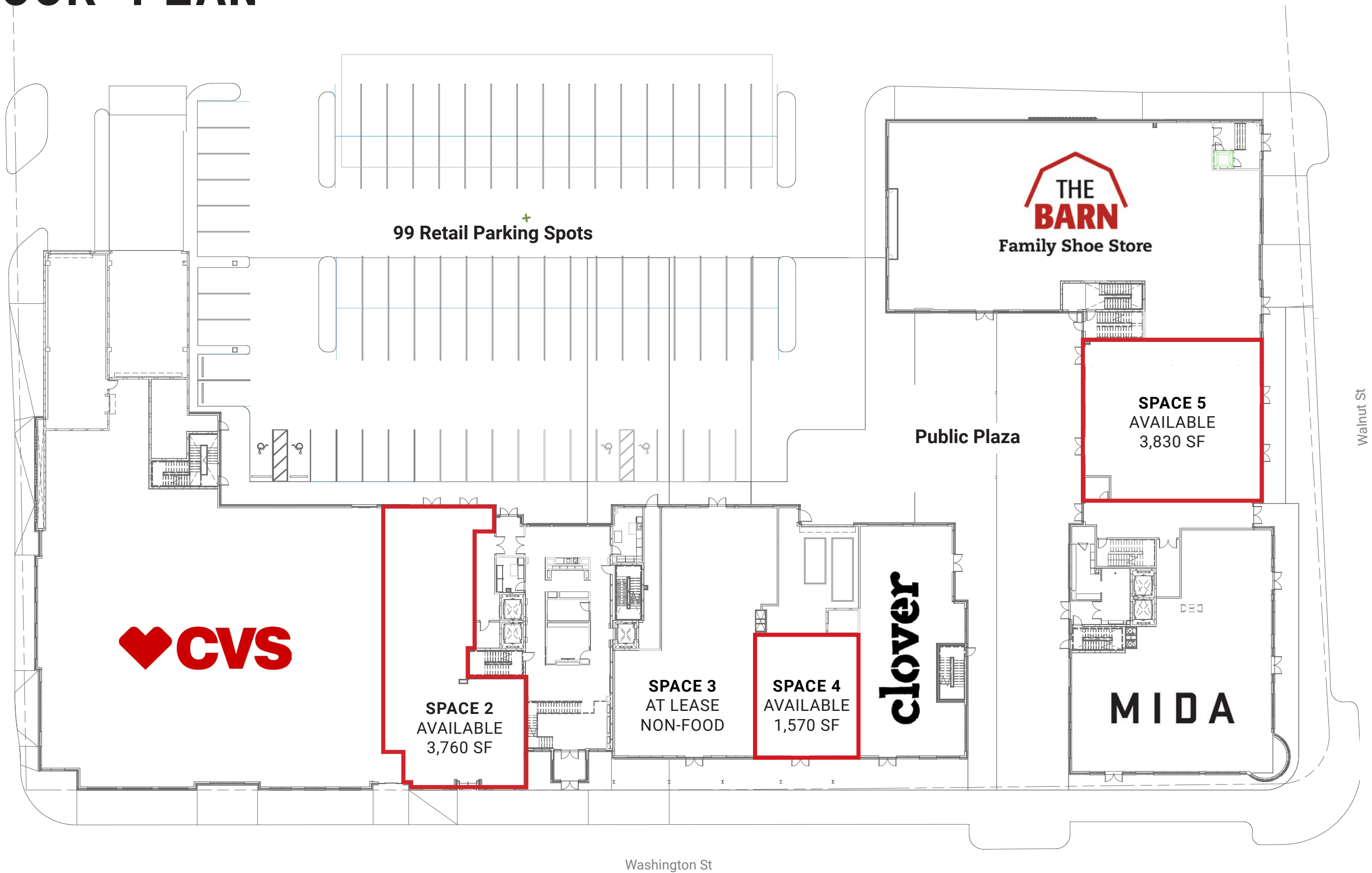

— LET'S TALK

Graffito is seeking dynamic local retailers to populate the ground floor of the project.

**1,570-3,830 SF
AVAILABLE NOW**

Jesse Baerkahn
jesse@graffito.com
617.401.2871

Dave Downing
dave@graffito.com
617.401.2871

Angela VanArsdale
angela@graffito.com
978.766.5142

