

212 STUART STREET JEWEL BOX RESTAURANT OPPORTUNITY



PROJECT ORIENTATION

At the intersection of Boston's bustling Theater District, quaint Bay Village neighborhood and dense Back Bay community is 212 Stuart Street, a new 126-unit luxury high-rise residential building that boasts a highly visible 1,246 square foot retail corner facing the Boston Park Plaza.

This one-of-a-kind retail opportunity benefits from tremendous visibility off the main pedestrian connection to Bay Village, strong transient traffic from the Back Bay, a rejuvenated theater scene, nearby dining and drinking establishments and popular hotel accommodations within steps of the front door.



29,000

residents living within
a 1/2 mile radius



3,700

businesses within
a 1/2 mile radius



90,000

employees within
a 1/2 mile radius

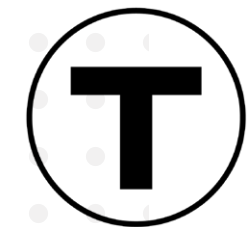

16,000

daily entries at
Back Bay T-Station

SITE PLAN

RESTAURANT ENTRANCE

BUILDING LOBBY

RESTAURANT
OPPORTUNITY
1,246 SF

THE OPPORTUNITY

Jewel box restaurant space at the base of Boston's newest luxury residential building in the Bay Village neighborhood. The space has floor to ceiling windows, unparalleled visibility and huge patio at the gateway to Bay Village from the Back Bay.



AVAILABLE NOW



1,246 SF



15' CEILINGS



60' OF FRONTAGE



EXPANSIVE OUTDOOR PATIO

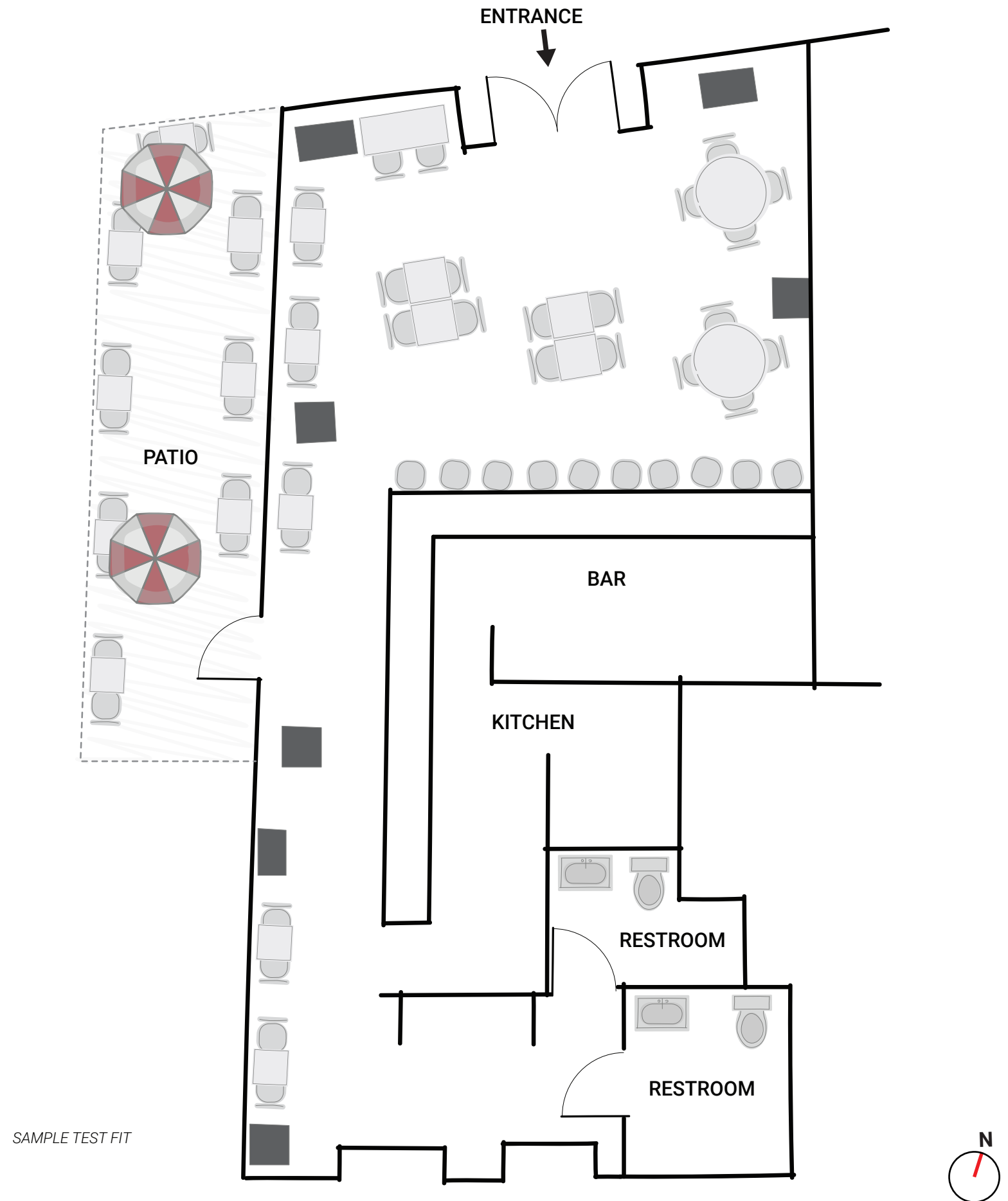

LET'S TALK

Graffito is seeking a best-in-class, independent restaurant team to anchor the ground floor of the building with a one-of-a-kind restaurant concept.



Boston Park Plaza



Mike & Patty's

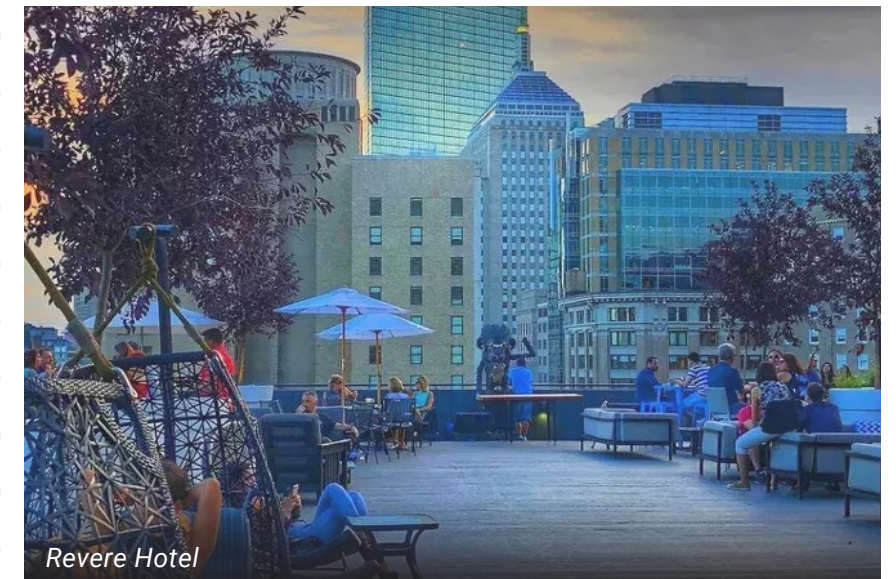

Revere Hotel



Wang Theater

Dave Downing
dave@graffito.com
617.401.2871

Angela VanArsdale
angela@graffito.com
978.766.5142