

# CAMBRIDGE MARKET CENTRAL RETAIL OPPORTUNITIES





# PROJECT ORIENTATION

“Central Square is the epitome of urbanism: no other district of similar size in Boston offers the same diversity and intensity of activities. In all of the Boston area, Central is truly special.”

– *Red Ribbon Report*

Market Central is uniquely positioned in the heart of Central Square where Massachusetts Avenue meets Main Street. This 308-unit mixed-use residential project includes 15,000 sf of ground floor retail fronting the Jill Brown Rhone Park along Massachusetts Avenue and Columbia Street.





# LOCATION

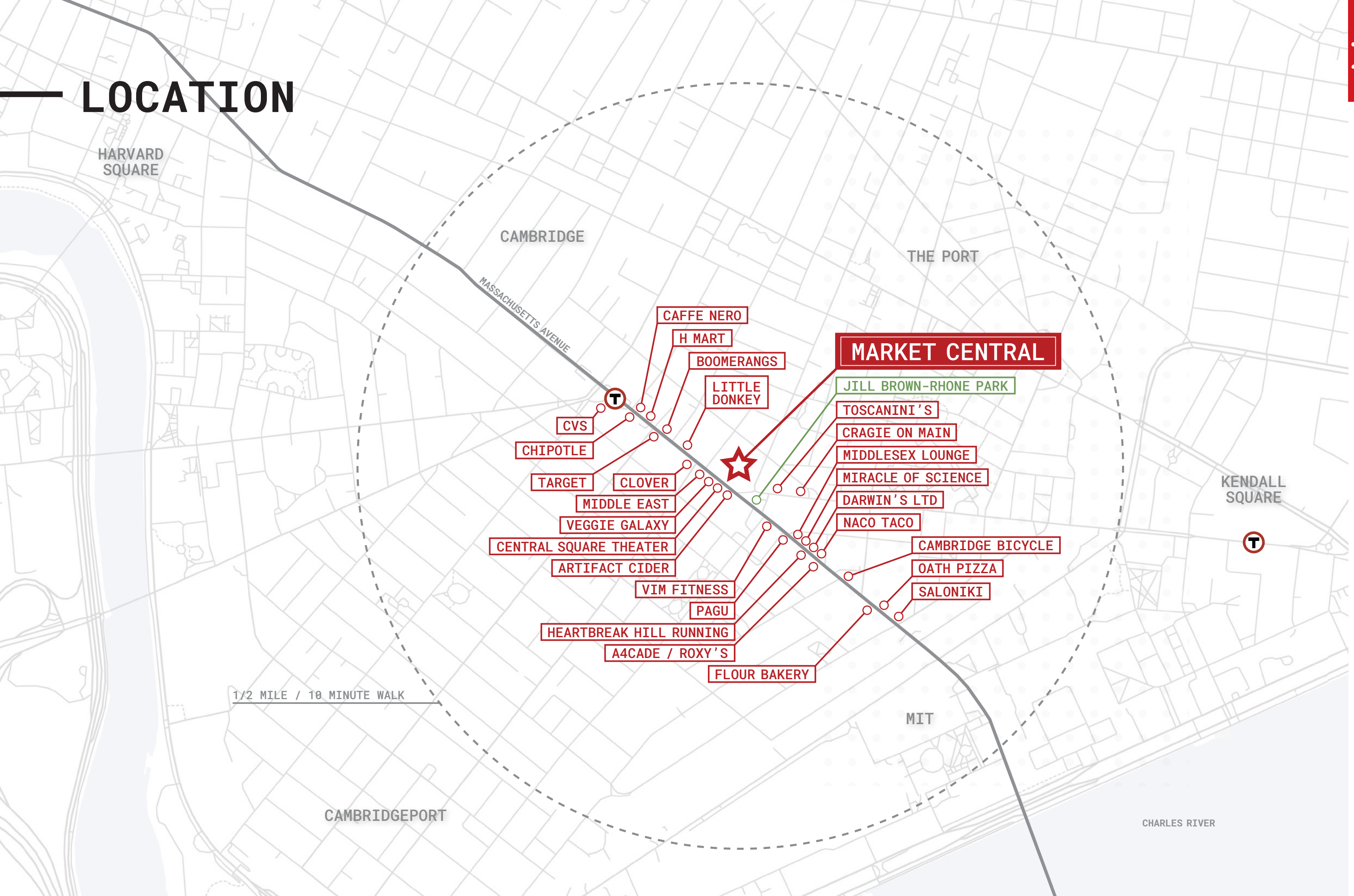

# IN THE NEIGHBORHOOD



**1,300**

businesses within  
a half-mile radius



**14,000**

employees within  
a half-mile radius

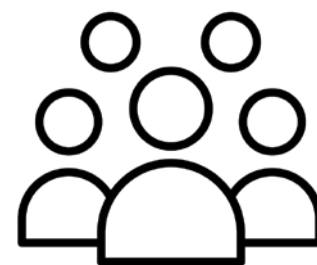

**21,100**

people living within  
a half-mile radius

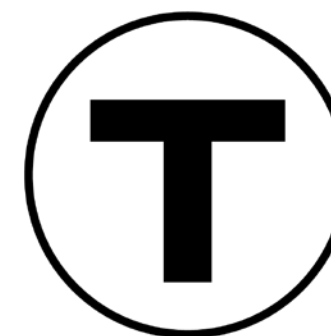

**15,500**

daily red line ridership at  
the Central Square station

## LARGEST EMPLOYERS:







Vibrant ground floor retail along Massachusetts Avenue





Neighborhood retail along Columbia St.



# THE OPPORTUNITY

Highly desirable neighborhood retail opportunities varying from 450-1,500 sf along Columbia Street across from the new boutique hotel, 907 Main. Visible from Massachusetts Avenue with through-traffic to the surrounding Port and Mid Cambridge neighborhoods. Easy access to the subway, public parking lots and busy bike routes.



AVAILABLE NOW



12' + CEILINGS



TURNKEY RETAIL SPACES



VISABLE SIGNAGE OPPORTUNITIES

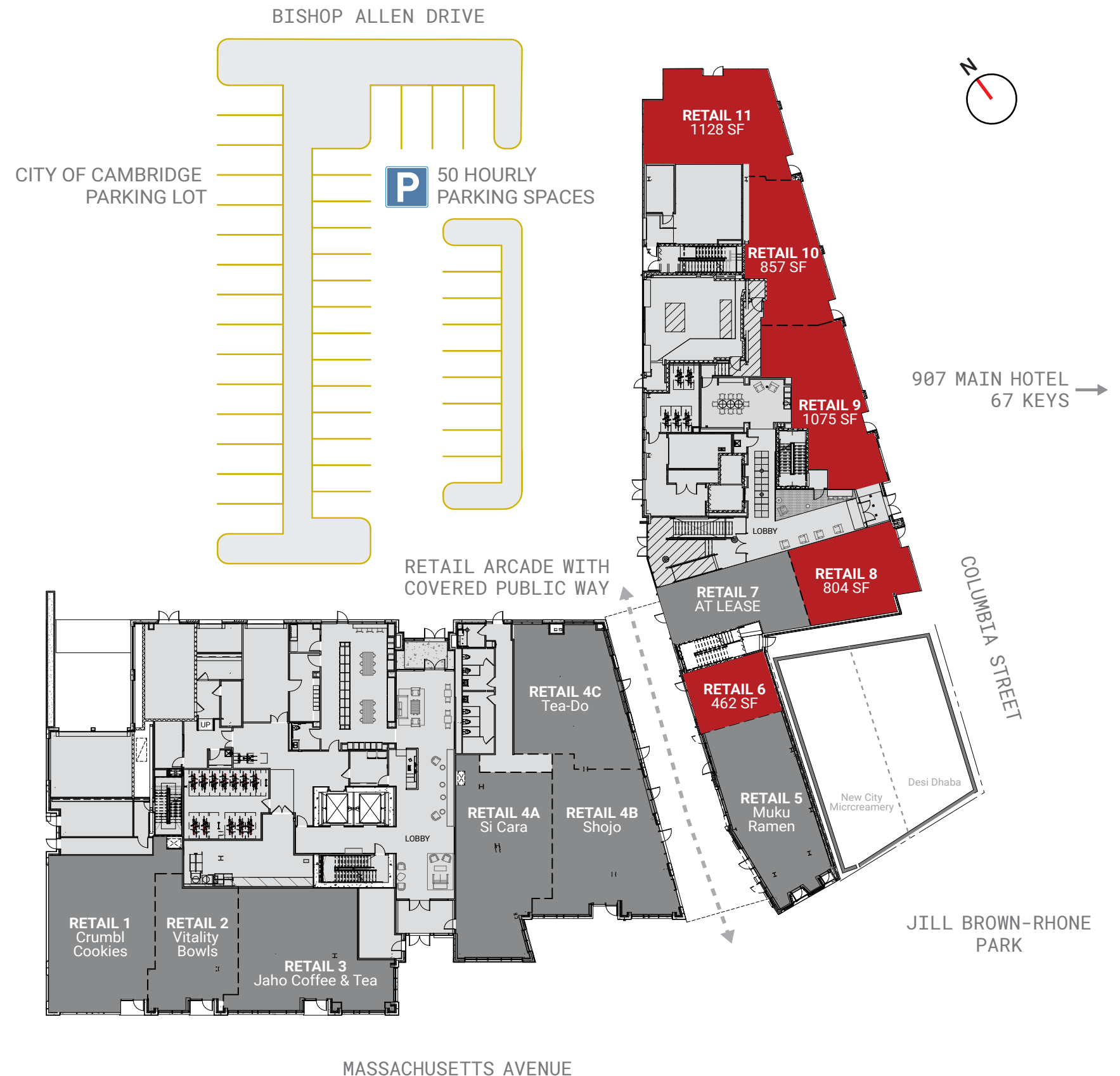



# LET'S TALK

Graffito is seeking a mix of unique, independent food, retail, and service businesses to join the incredible mix of ground floor tenants open at Market Central.

**NOW AVAILABLE!**

**Dave Downing**  
dave@graffito.com  
617.401.2871

**Tania Celestin**  
tania@graffito.com  
781.510.1307

