

# BOSTON PUBLIC MARKET SECOND-GENERATION RETAIL OPPORTUNITY





# PROJECT ORIENTATION

**Boston Public Market is an indoor year-round marketplace featuring the best local businesses in the region. Located in the heart of Downtown Boston along the Rose Kennedy Greenway, it is one of the busiest and densest intersections in the City of Boston with a vibrant office and tourist population that is active 24/7.**

This second-generation opportunity is being offered at the corner of Congress and Sudbury Streets. It is located within a short walk to the North End, TD Garden, Faneuil Hall Marketplace, and the Financial District. Additionally, the building sits directly above the Haymarket MBTA station and benefits from a validated parking program in the parking garage above the Market.





# LOCATION

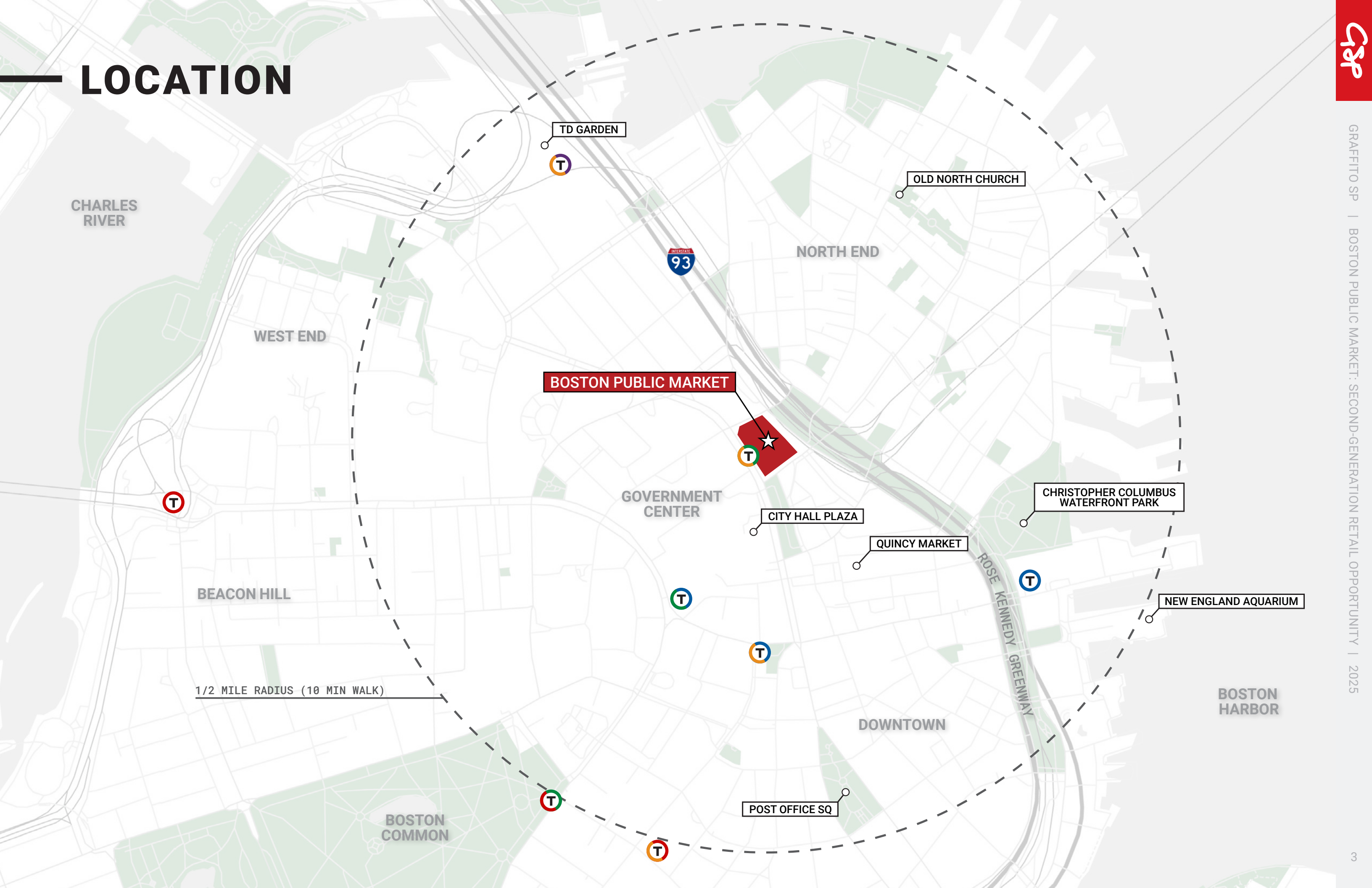

# IN THE NEIGHBORHOOD



**264,000**

total daytime population  
within one-mile radius



**20,500**

residents within  
one-mile radius



**\$192,000**

average HH income  
within one-mile radius



**5,000**

daily ridership at Haymarket  
MBTA station

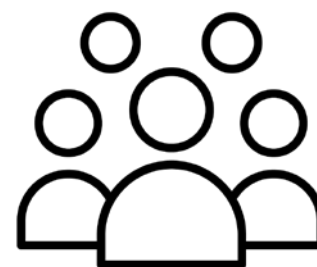

**2M+**

annual visitors to the  
Boston Public Market

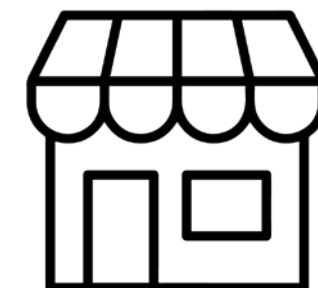

**25+**

local vendors at  
Boston Public Market

# FLOOR PLAN

This 3,300 SF second-generation retail space features existing restaurant/kitchen infrastructure, high ceilings, expansive frontage, and great signage opportunities. This opportunity has direct access to the Boston Public Market and benefits from immediate adjacency to the Greenway, City Hall Plaza and the newly developed One Congress, a 1 MSF fully occupied Class A office space.



AVAILABLE Q3 2025



18'+ CEILINGS



POTENTIAL PROGRAMMABLE OUTDOOR SPACE



MAIN FRONTAGE ALONG CONGRESS STREET



VALIDATED GARAGE PARKING



DIRECT ACCESS TO LOADING DOCK

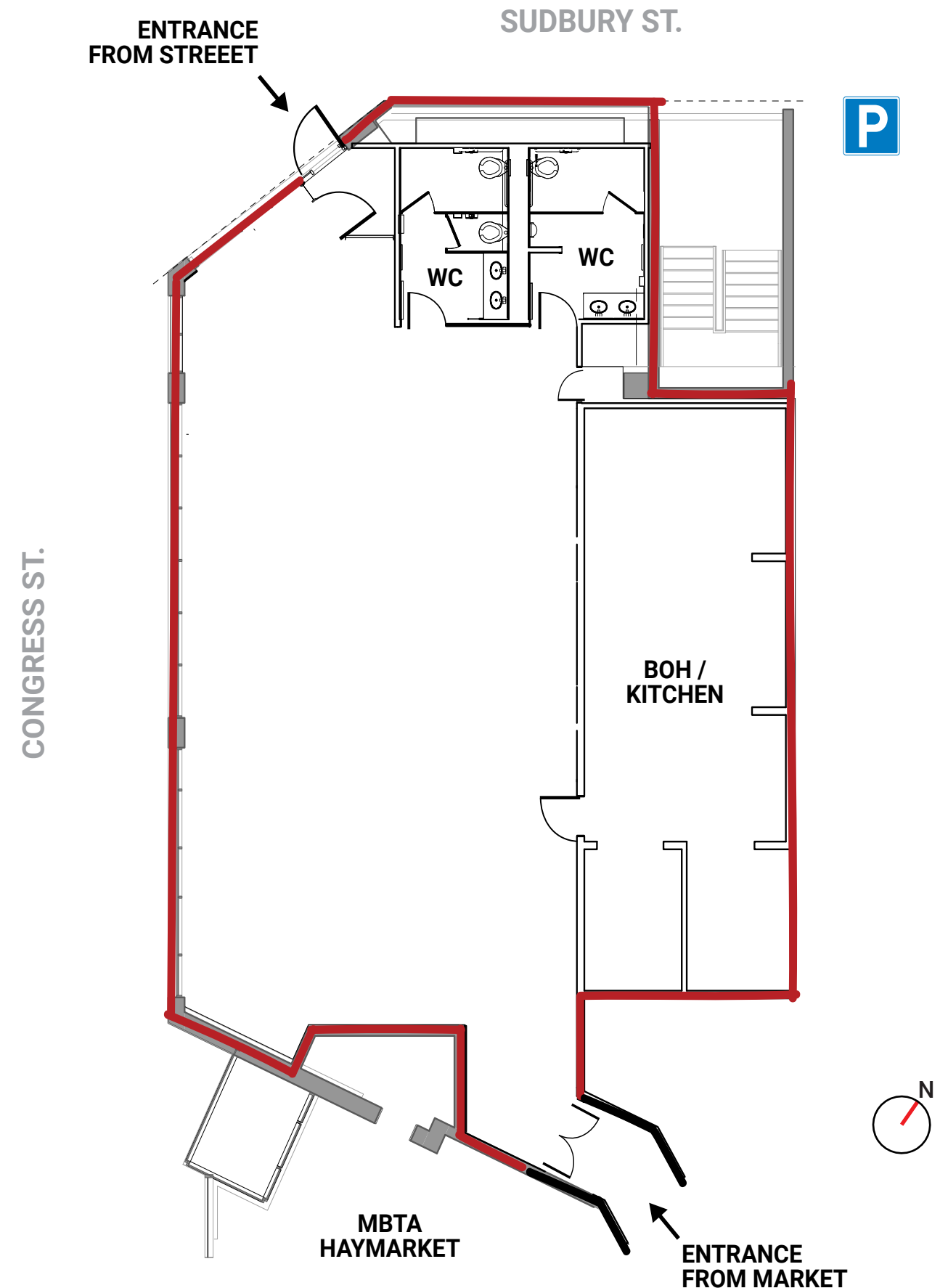





Located at the key corner of  
Congress & Sudbury Streets





Potential outdoor space  
along Congress Street



# LET'S TALK

Graffito is seeking a unique and dynamic retailer or restaurateur to serve the dense and bustling population of residents, employees, and tourists that are frequenting the Boston Public Market, other tourist attractions, and the surrounding trade area.

**Jesse Baerkahn**  
jesse@graffito.com  
617-699-6171

**Tania Celestin**  
tania@graffito.com  
781.510.1307

